

MCP BRAKES

To place an ORDER

1-513-539-9900

MCP STANDARD REAR BRAKES

REAR BRAKE KITS

Includes- Master Cylinder, Caliper,
Disc, Hub, Line & Fluid

Part No.	Description	Racer Net
MCP2100	1" Brake Kit	\$ 171.50
MCP2250	1 1/4" Brake Kit	171.50



MASTER CYLINDER & PARTS KITS

Part No.	Description	Racer Net
MCP151	Rebuild Kit	\$ 10.50
MCP875	Master Cylinder Assembly	46.87
MCP877	Master Cylinder Cover	4.87
MCP878	Master Cylinder Cover O-ring	.30
MCP879	Master Cylinder Filler Cap	.50
MCP879-M	Metal (Socket Head) Filler Cap	.50
MCP880	Master Cylinder Screw	.30
MCP881	Master Cylinder Screw O-ring	.20
MCP882	Master Cylinder Lever Arm	6.75
MCP883	Master Cylinder Push Rod	3.93
MCP884	M/C Lever Arm Pivot Pin	.30
MCP885	M/C Lever Push Rod Pivot Pin	.20
MCP886	Master Cylinder Boot	2.50
MCP887	Master Cylinder Piston with seals	6.75
MCP888	Master Cylinder Piston O-ring	.30
MCP889	Master Cylinder Cup Seal	1.25
MCP890	Master Cylinder Snap Ring	.50
MCP891	Master Cylinder Spring	1.00

HUBS (4 HOLE MOUNT)

Part No.	Description	Racer Net
MCP100	1" Brake Hub	\$ 20.00
MCP125	1-1/4" Brake Hub	20.00
MCP125L	1-1/4" Lightweight Brake Hub	25.00
MCP140	40 mm Brake Hub	40.00

BRAKE PADS (SOLD INDIVIDUALLY)

Part No.	Description	Racer Net
MCP1383BN	Standard (black)	\$ 10.87ea.

BRAKE CALIPER & PARTS

Part No.	Description	Racer Net
MCP152	Rebuild Kit	\$ 13.12
MCP1375	Caliper Assembly	94.12
MCP1377	Caliper Half (Complete with Pad)	47.00
MCP1378	Caliper Piston with Seals	6.75
MCP1379	Caliper Piston O-Ring	.45
MCP1380	Caliper Adjuster Assembly	6.00
MCP1380-4	Caliper Sleeve	1.50
MCP1381	Adjuster restraint O-Ring	.50
MCP1382	Bleed Screw Adapter with Screw	3.25
MCP1382-1	Caliper Bleed Screw	1.05
MCP1382-2	Caliper Screw Adaptor only	2.20
MCP1384	Shims	2.00

DISC (4 HOLE MOUNT)

Part No.	Description	Racer Net
MCP711S	1/8" x 7.1" Super Slot Disc	\$ 40.00
MCP712	3/16" x 7.1" Steel Slot Disc	30.00
MCP775	3/16" x 7-3/4" Steel Slot Disc	23.25
MCP713	1/4" x 7.1" Steel Slot Disc	31.50
MCP1775	1/4" x 7.75" Steel Slot Disc	31.50

MISCELLANEOUS

KM215

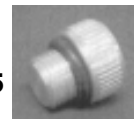

Part No.	Description	Racer Net
KM215	Billet Master Cylinder Filler Cap	\$ 5.50

BRAKE ROTOR GUARDS

Heavy gauge stamped steel rotor guard for protection
between the driver's seat and brake rotor.

Part No.	Description	Racer Net
G4665	Brake Rotor guard (7-1/8 inch disc)	\$ 7.97
G4652	Brake Rotor guard (6 inch disc)-Minilite	7.88



PRICES SUBJECT TO CHANGE WITHOUT NOTICE

MCP BRAKES

To place an ORDER

1-513-539-9900

MCP MINILITE REAR BRAKES

MINILITE KIT

Includes- Master Cylinder, Caliper, Disc, Hub, Line & Fluid

Part No.	Description	Racer Net
MCP2112	1-1/4" Minilite Brake Kit	\$ 217.35



MASTER CYLINDER

Part No.	Description	Racer Net
MCP750	Master Cylinder for Minilite	\$ 69.37
MCP251	Master Cylinder Rebuild Kit for Minilite	10.50

CALIPER

Part No.	Description	Racer Net
MCP1125	Minilite Caliper	\$ 107.63
MCP352	Minilite Caliper Rebuild Kit	12.75

BRAKE HUB (3 HOLE MOUNT)

Part No.	Description	Racer Net
MCP125M	1-1/4" Minilite Brake Hub	\$ 20.63

BRAKE PADS (SOLD INDIVIDUALLY)

Part No.	Description	Racer Net
MCP554B	Standard (Minilite Brake) BLACK	\$ 10.13ea.

BRAKE DISC (3 HOLE MOUNT)

Part No.	Description	Racer Net
MCP611	1/8" x 6" Super Slot Minilite Disc	\$ 30.00

MISC. PARTS

Part No.	Description	Racer Net
APBF8	Silicone brake fluid (8 oz.)	\$ 7.95
APBF32	Silicone brake fluid (32 oz.)	23.25
MCP300	Brake line (per foot)	.50
MCP316	Straight fitting with cap & ferrel	3.00
MCP315	1/8" pipe plug	1.00
MCP390	90 degree fitting	4.00
MCP317	Full T fitting	6.75
MCP398	Cap	1.00
MCP399	Ferrule	.50

BRAKE BLEEDER KIT

(FOR MCP OR ENGINETICS)



Part No.	Description	Racer Net
ENG912	Brake Bleeder Kit (Less Fluid)	\$ 12.00

BRAKE FLUID (Silicone .5)

This can be used in either MCP & ENGINETICS!

Part No.	Description	Racer Net
APBF8	8 oz. Silicone brake fluid	\$ 12.75
APBF32	32 oz. Silicone brake fluid	23.25

HYDRAULIC BRAKE LINE

Super tough 2500 p.s.i. nylon tubing. Resists abrasion like steel. Replaces standard hydraulic line on all Karts. Also great for throttle cable housings, and the price is right. Sold per foot - 3/16"

Part No.	Description	Racer Net
MCP300	Brake line	\$.50 ft.

PRICES SUBJECT TO CHANGE WITHOUT NOTICE

ENGINETIC BRAKES

To place an ORDER

1-513-539-9900

#600 MASTER CYLINDER REPAIR PARTS

Part No.	Description	Racer Net
ENG602	Master cylinder cap	\$ 4.88
ENG603	Cap plug	.50
ENG604	Cap screws (4 required)	.30
ENG105	Cap gasket	1.25
ENG106	Pivot pin	.30
ENG611	Spring	1.25
ENG613.1	"O" ring	.50
ENG615	Lever	6.00
ENG125	Cup seal	1.25
ENG126	Piston	7.50
ENG908	Dust shield (includes washer & cotter pin)	6.38
ENG904	Master cylinder repair kit	13.50
MCP316	Complete Str. fitting	3.00

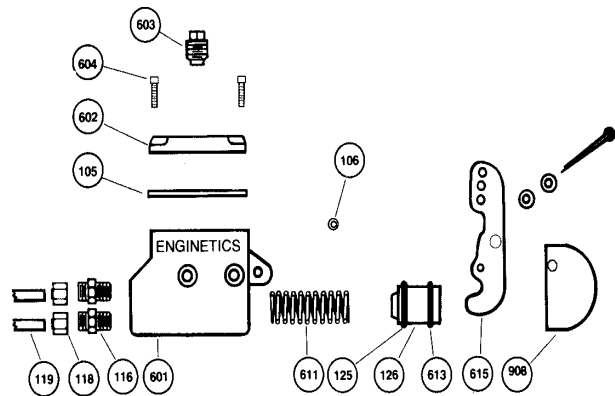

1700 PRO CALIPER PARTS

Part No.	Description	Racer Net
ENG1703	Transfer "O" ring	\$.40
ENG205	Piston "O" ring (2 required)	.45
ENG1706	Caliper return springs (4 required)	1.50
ENG1707	Sleeve w/adjustor ring (4 required)	5.63
ENG1708	Pad retaining screw (4 required)	1.00
ENG1709	Assembly screw (2 required)	.30
ENG907	"Pro" caliper repair kit	13.28
ENG607	Bleeder screw (2 required)	1.00
MCP316	Complete Str. fitting	3.00
MCP1383BN	Standard Metallic Pads (Black)	10.87

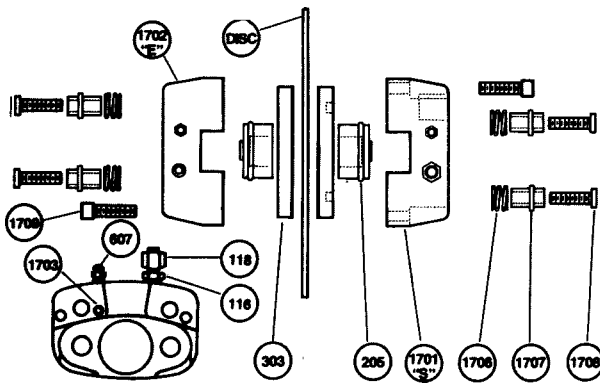

700 "EXPERT" CALIPER PARTS

Part No.	Description	Racer Net
ENG204	Caliper piston (2 required)	\$ 7.13
ENG205	Piston "O" ring (2 required)	.45
ENG206	Return spring (4 required)	1.25
ENG707	Retainers (4 required)	1.00
ENG708	Shims (14 required)	1.00
ENG905	"Expert" caliper repair kit	14.63
ENG607	Bleeder screw (2 required)	1.00
MCP1383BN	Standard Metallic Pads (Black)	10.87

700B BILLET CALIPER PARTS

ENG1706	Caliper return spring (4 required)	1.50
ENG1707	Sleeve with adjuster ring (4 required)	5.63
ENG1708	Pad retaining screw (4 required)	1.00

NOTE: "700B" caliper uses same parts as "700 Expert" caliper except for the above

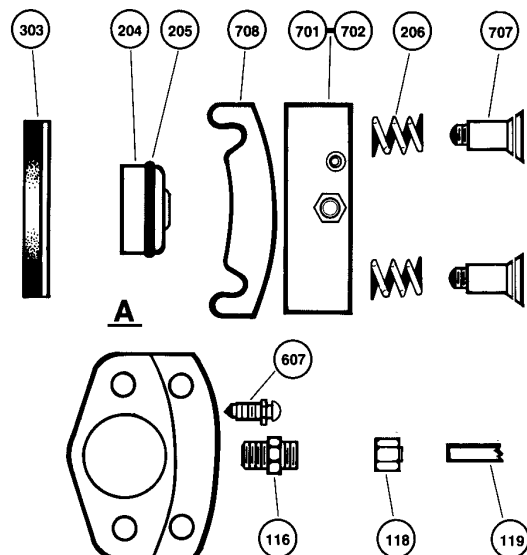

DISC-CALIPER BRAKE & ACCESSORIES

To place an ORDER

1-513-539-9900

BRAKE CALIPER

Part No.	Description	Racer Net
CC218070	Caliper Assembly	\$ 71.23
CC217937	Caliper Mounting Bracket	21.77
CC211673A	Back up plate for pad	6.00 ea.
CC211674A	Pad for caliper	6.75 ea.

COMET DISC-CALIPER BRAKE

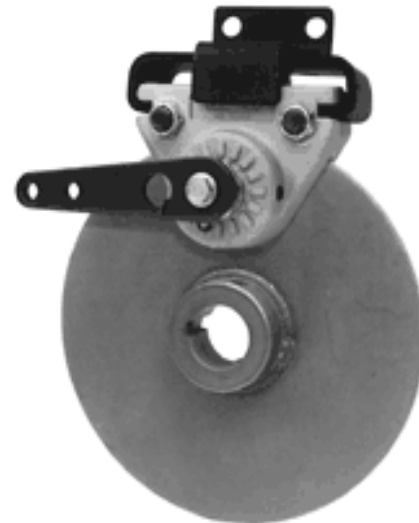

DISC & HUB

Part No.	Description	Racer Net
CC212369	1" Hub- 6-3/8" Brake Disc	\$ 30.00
CC212364	1" Hub- 7-7/8" Brake Disc	26.30
KM281	1-1/4" Hub- 7"(3/16" Thick Brake Disc)	25.95

STENS MECHANICAL BRAKE CALIPER

Part No.	Description	Racer Net
APSMBC	Mechanical Brake Caliper	\$ 14.95
APSMBCP	Replacement Pad Set	3.95 /set



Caliper is 2 1/4" long and 2 1/4" wide.
Caliper has a 1 5/8" bolt pattern.

BRAKE BANDS & ACCESSORIES

Part No.	Description	Racer Net
CC10978	4 " Brake Band	\$ 11.95
CC200847	Cable Anchor Pin	7.95
KMTC92	92" Cable & Housing	3.95
CC200026	4 1/4" Brake drum-3 hole with 2 13/16" bolt pattern with 2 1/8" center hole	8.95
CC207505A	4 1/4" Brake drum for 1" live axle with 1/4" keyway with set screws	27.52



PRICES SUBJECT TO CHANGE WITHOUT NOTICE

BRAKES

To place an ORDER

1-513-539-9900

AZ2552
kit

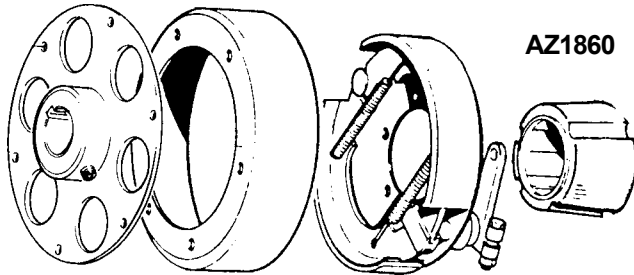

AZUSA 6" INTERNAL EXPANDING BRAKES

Part No.	Description	Racer Net
AZ2552	Complete Kit, Includes 6" Brake, Plated Drum, Mounted Hub	\$ 84.95
AZ8101	Shoes w/bonded lining, pair	19.95
AZ8455	Spring, short (2 required)	1.35
AZ8456	Spring, long (2 required)	1.75
AZ8147	Arm Assembly Kit, w/fasteners	12.95
AZ8148	Cam Assembly	8.95
AZ1860	Spacer, brake to hanger	5.25

NOTE:

AZ1860 -SPACER COMES WITH AZ2552 BRAKE KIT.

AZUSA 5" BRAKES

- * Only 16 ounces total weight
- * Premium bonded lining
- * Sturdy and allows for 8 positions

Part No.	Description	Racer Net
AZ2530	Azusa 5" brake assembly	\$ 33.95
AZ2533	Actuating Cam	6.50
AZ2537	Brake arm	3.50
AZ2538	Lined shoes, pair	12.95
AZ2539	Spring	1.00



5" BRAKE DRUM

* 3-1/4" bolt circle

Part No.	Description	Racer Net
AZ2542	5" Brake Drum w/o flange	\$ 10.95



- * All self contained
- * Keyway for live axle mounting
- * Dual pads of molded lining
- * Self-aligning to disc

AZUSA POSI-STOP DISC BRAKE

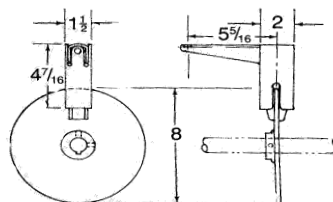

Part No.	Description	Racer Net
AZ1822	Brake Assembly w/o disc	\$ 34.95
AZ1823	Disc only, 8" dia., 1" bore	21.95
AZ8118	Shoe w/lining (2 required)	5.95

PRICES SUBJECT TO CHANGE WITHOUT NOTICE